

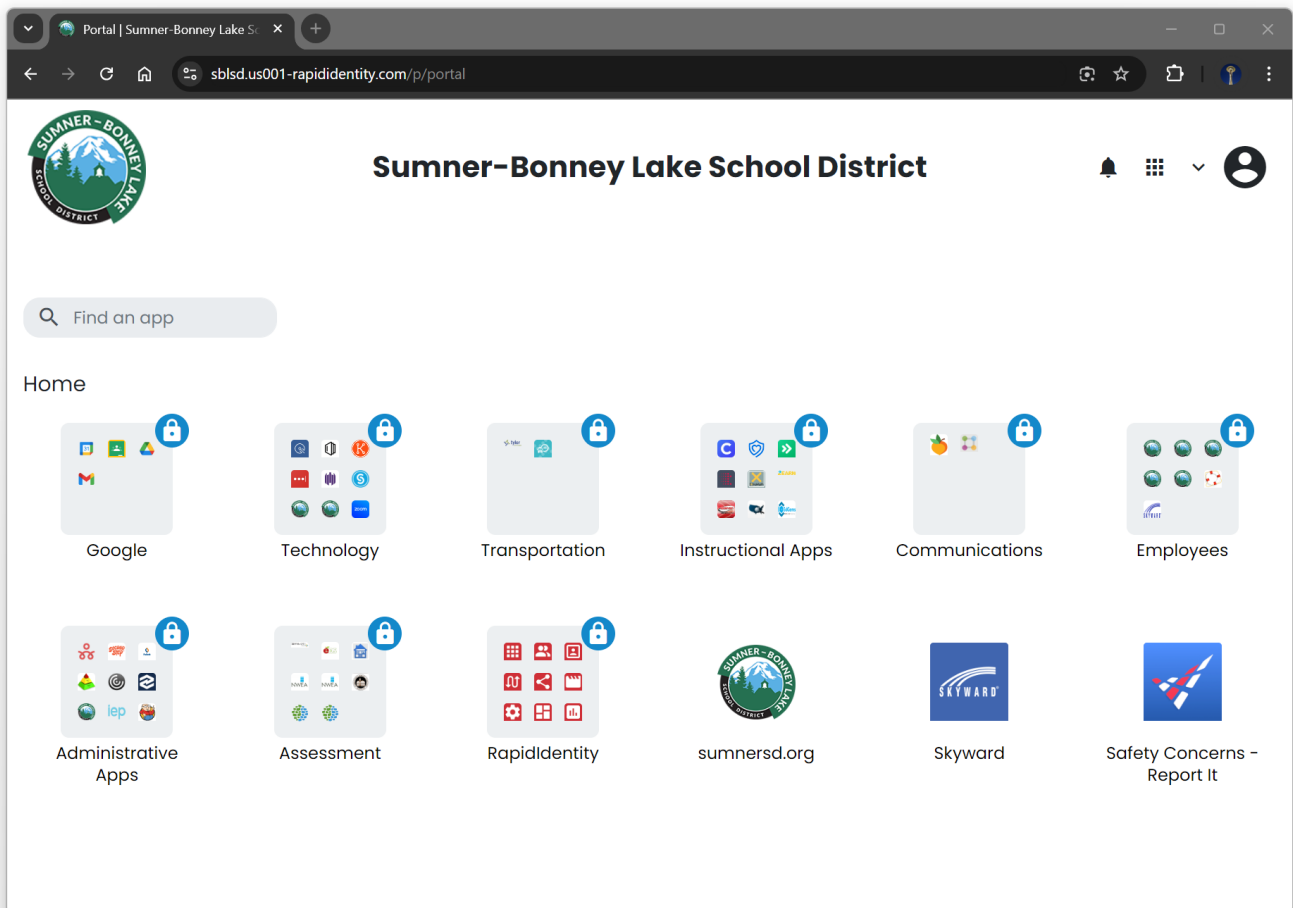



# New RapidIdentity Dashboard 2024



## Settings



< Settings

Recents

☐ On

☒ Off

Density

☒ Comfy

☐ Compact

App Size

☒ Small

☐ Medium

☐ Large

Mode

☒ Light

☐ Dark

Sort By

☐ Ascending (A-Z)

☐ Descending (Z-A)

☒ Custom

Setting	Description
Recents	Toggles showing your recently opened apps at the top of the page
Density	Adjusts the spacing between folder and app icons
App Size	Adjusts the size of folder and app icons
Mode	Switches between a light and dark theme
Sort By	Adjusts the order which folders and apps are sorted by

# Custom Apps

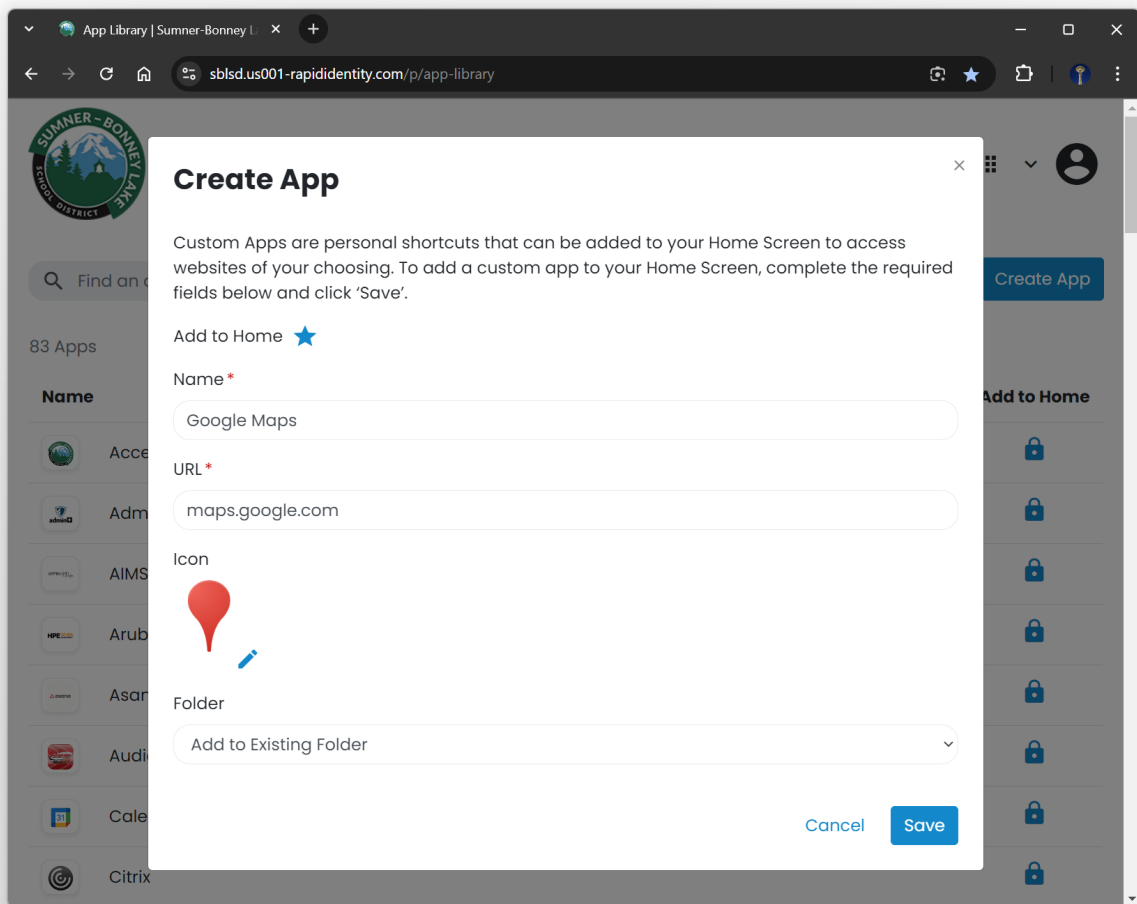

# Switching Between the New & Old Dashboards

Switch to the **old** dashboard

Switch to the **new** dashboard

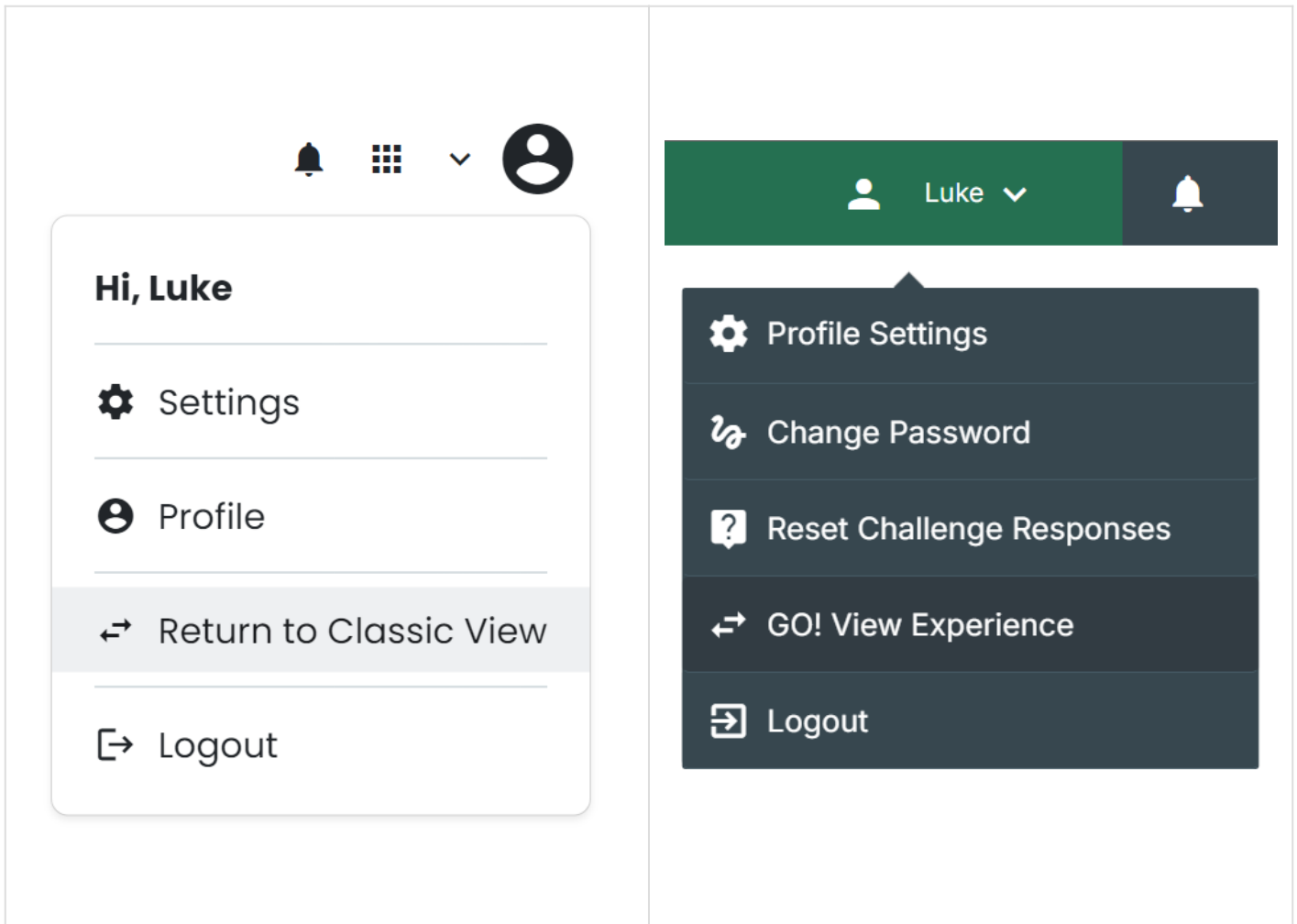

# Get Early Access to The New Dashboard

1. Open the [RapidIdentity Requests](#) module
2. Select **Entitlements** > **Catalog** from the menu on the left
3. Locate the **New RapidIdentity Dashboard** entitlement, then click the **Request** button which will open a popup

4. Click the **Request** button in the popup

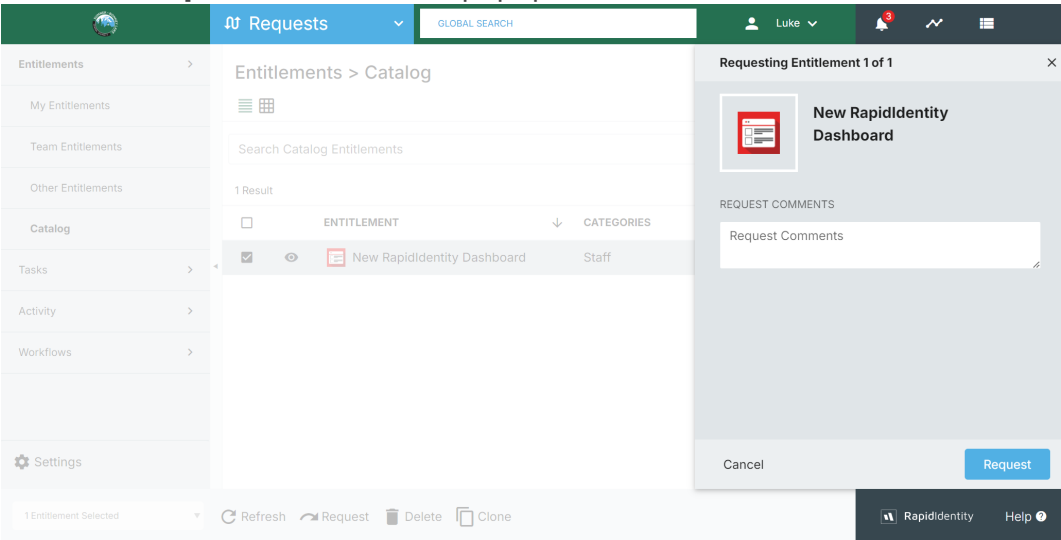

5. Wait a few moments for the request to automatically be fulfilled, then navigate to [sblsd.us001-rapididentity.com](https://sblsd.us001-rapididentity.com).

Revision #24

Created 9 August 2024 20:38:25 by Luke Knowles

Updated 12 August 2024 18:02:01 by Luke Knowles